

PLAT OF SURVEY

A PARCEL OF LAND SITUATED IN THE NORTHEAST QUARTER OF SECTION 20 AND IN THE SOUTHEAST QUARTER OF SECTION 20 AND IN THE NORTHWEST QUARTER OF SECTION 21, TOWN 6 NORTH, RANGE 4 EAST, SPRINGFIELD TOWNSHIP, WILLIAMS COUNTY, OHIO. LOCATED WITHIN THE NORTH AND THE EAST OF THE FIRST PRINCIPAL MERIDIAN OF THE ORIGINAL LAND SUBDIVISIONS OF OHIO.

NE COR, NW 1/4, SECTION 21

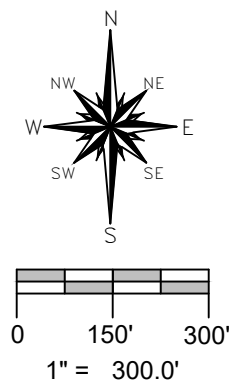

TANGENT TABLE

- A - N 22°18'52" E 64.39'
- B - N 3°08'16" E 100.00'
- BA - N 6°09'30" W 100.00'
- C - N 32°00'53" W 200.00'
- D - N 40°52'06" W 100.00'
- E - N 55°23'55" W 50.00'
- F - N 69°04'04" W 50.00'
- G - S 84°55'59" W 50.00'
- H - S 51°01'23" W 200.00'
- J - S 45°28'25" W 150.00'
- K - S 38°34'19" W 60.02'
- KA - S 38°34'19" W 139.98'
- L - S 57°02'54" W 150.00'
- M - S 64°54'51" W 146.40'
- MA - S 64°54'51" W 53.60'
- N - S 83°55'41" W 200.00'
- P - N 75°01'23" W 200.00'
- Q - N 40°08'28" W 313.75'(M) 310.07'(PS)
- R - N 27°37'36" W 165.12'
- S - N 19°11'06" W 216.33'
- T - N 0°36'28" W 172.07'
- U - N 4°02'21" W 192.24'
- V - N 11°20'47" W 243.03'
- W - N 2°44'15" W 142.64'
- X - N 21°28'32" E 157.46'
- Y - N 87°43'58" E 90.00'
- Z - S 47°58'57" E 75.00'
- AA - S 13°07'59" E 250.00'
- BB - S 12°23'57" E 250.00'
- CC - S 28°39'27" E 175.00'
- DD - S 44°47'08" E 150.00'
- EE - S 59°23'11" E 200.00'
- FF - S 85°41'25" E 100.00'
- GG - N 63°42'37" E 100.00'
- HH - N 13°17'34" E 100.00'
- JJ - N 22°08'11" W 75.00'
- KK - N 55°46'29" W 75.00'
- LL - N 48°35'46" W 75.00'
- MM - N 20°53'19" W 100.00'
- NN - N 6°27'57" W 200.00'
- PP - N 4°33'40" E 200.00'
- QQ - N 32°04'15" E 35.00'

REFERENCE SURVEYS

- Volume 8R Page 285
- Volume 14R Page 012
- Volume 16R Page 234
- Volume 16R Page 247
- Volume 18R Page 110
- Volume 20R Page 316
- Volume 24R Page 293
- Volume 24R Page 305
- Volume 27R Page 069

D Fitzenrider
OR 232 PG 904

Paul V & Linda S Merillat
Deed OR 305 PG 3687

Paul R & Patti A Robinson
Deed OR 290 PG 1976

H Knapp
D 320 PG 828

H Knapp
OR 29 PG 893

Jose & Laura
Vasquez

K & R Ruffer
OR 242 PG 1403

M & E Psurny
OR 56 PG 1003

Reggie Buehrer
OR 334 PG 970

Reggie Buehrer
OR 334 PG 970

John & Opaljean Thiel
Deed Vol 320 PG 647

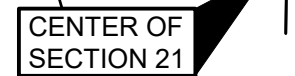
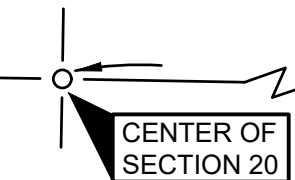

SURVEY LEGEND

- Placed 5/8" Rebar w/ Cap
- × Found PK Nail
- Point Established this Survey
- Found Iron Pin or Pipe
- ⊠ Found Monument Box
- ⊞ Found Railroad Spike
- × Placed MAG Nail

GENERAL OCCUPATION NOTE:

Random fences existed along the North & South boundaries of this parcel. Other boundaries of these properties are agricultural, wooded and water.

SURVEYED FOR:
Paul Robinson
Deed OR 253 PG 1654

74.265 ACRES
NO BUILDINGS

27.613 ACRES
NO BUILDINGS

(27.329 AC. NE 1/4 SEC 20)

(0.284 AC. SE 1/4 SEC 20)

(74.265 AC. NW 1/4 SEC 21)

I HEREBY CERTIFY THAT I HAVE SURVEYED THE PREMISES SHOWN ON THE PLAT ABOVE. ALL DIMENSIONS ARE SHOWN IN FEET AND DECIMALS THEREOF. SINCE THIS SURVEY DOES NOT INCLUDE A TITLE SEARCH, THERE COULD BE EASEMENTS OR OTHER ENCUMBRANCES UPON THE LAND WHICH ARE NOT SHOWN ON THIS SURVEY PLAT. IF THESE ARE REQUIRED, PLEASE FURNISH THE NECESSARY INFORMATION. THE BEARINGS AND DISTANCES SHOWN ON THE PLAT ABOVE ARE BASED ON STATE PLANE COORDINATES, SP63 ZONE-OHIO NORTH. THIS SURVEY HAS BEEN RECORDED IN VOL. 27R PAGE 337 OF THE WILLIAMS COUNTY SURVEY RECORDS.

Brian M. Wieland
BRIAN M. WIELAND - REGISTERED SURVEYOR NO. 8286



DATE: 2-26-20 JOB: 19-103

WIELAND SURVEYING & ENGINEERING, LLC
14067 COUNTY ROAD 20
WEST UNITY, OH 43570
419-553-0112 VOICE

brian@wielandsurveying.com